

INSTRUCTION

Pascala
901803.004.1



RZB
LIGHTING

~ 220 - 240 V 50/60 Hz IP 20 IK03

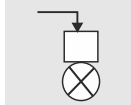
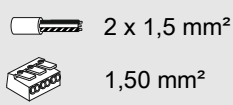

Umgebungstemperatur /
temperature ambiante
=> -20 °C ... + 25 °C

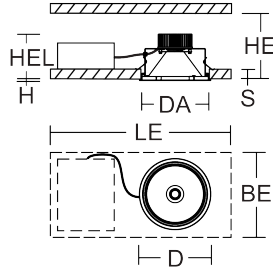

D 241, H 2, HEL 156



DA 228, HE 160,
S 6-35, LE 340, BE 540



1 kg

	Φ_{lm} [lm]	P_{lm} [W]	P_{lm} [W]			
--	-------------------------	---------------------	---------------------	--	--	--

LED 1700 11 1 x 24,8 W

CCT [K]	CRI	RG lm	EEK			
---------	-----	----------------	-----	--	--	--

4000 92 RG 1 D

I_{max} $I_{\text{max}}/2$ T50	B10 [St.]	B16 [St.]	C10 [St.]	C16 [St.]	COS φ
--	-----------	-----------	-----------	-----------	---------------

5 A / 50 μs 31 50 52 85 0,95

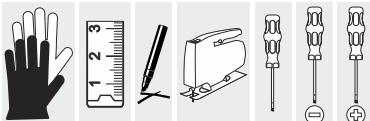



Allgemeine Sicherheitshinweise

- Der elektrische Anschluss muss ordnungsgemäß nach geltenden Normen und den nationalen sowie internationalen Sicherheits- und Unfallverhütungsvorschriften erfolgen.
- Beschädigte Leuchten dürfen nicht betrieben werden.
- Keine Haftung für Schäden durch unsachgemäßen Einsatz.
- Bei Instandsetzung nur Originalteile verwenden.
- Tragfähigkeit der Decke und Befestigungselemente sicherstellen.

Betrieb der Leuchte

- Die unzulässigen Umgebungstemperaturen reduzieren die Lebensdauer der Leuchte, im Extremfall droht der Frühausfall.
- Zur Vermeidung von EMV-Problemen die Durchgangsverdrahtung nicht entlang der Leuchtenverdrahtung führen.
- Steuereingänge von dimmbaren Leuchten mit handelsüblichen für Netzspannung geeigneten Leitungen anschließen.

Manipulationen unserer Produkte sind unzulässig

Veränderung, Umarbeitung, Umkennzeichnung von Produkten sowie deren Verpackung sind unzulässig und verletzen u.a. unsere eingetragenen Warenzeichenrechte. Solche Modifikationen können technische Eigenschaften unserer Produkte negativ beeinflussen, diese zerstören und möglicherweise Folgeschäden an anderen Objekten verursachen. Für durch derartige Modifikationen verursachte Schäden kann der Hersteller in keinem Fall verantwortlich gemacht werden.



General Safety Information

- Electric connection must be appropriate according to all applicable standards and other national and international safety and accident prevention regulations.
- Damaged luminaires must not be operated.
- No liability is accepted for damages resulting from improper use.
- Use genuine parts only for repair.
- Ensure stability of the ceiling and fastening elements.

Operation of the luminaire

- Exceeding the permissible ambient temperature will reduce the luminaire's lifecycle, resulting in premature failure in extreme cases.
- Avoid ESD problems by not routing feed-through wiring directly along the wiring of the luminaire.
- Connect control inputs of dimmable luminaires with standard cables suitable for power supply voltage.

Manipulation of our products is not permitted

Modifications, reworking, re-labelling of products as well as their package is not permitted and infringes, amongst others, our registered trademark rights. Such modifications may affect technical properties of our products, damage them and possibly cause consequential damage to other objects. The manufacturer shall not be responsible under any circumstances for damage caused by such modifications.



Bei Fragen zu unseren Symbolen, besuchen Sie folgende Webseite:
If you have any questions about our signs, visit the following website:



https://www.rzb.de/fileadmin/assets/downloads/PDF/RZB_Symbolklaerung.pdf

EEK 

Dieses Produkt enthält eine Lichtquelle der Energieeffizienzklasse D
entsprechend Verordnung (EU) 2019/2015

This product contains a light source of energy efficiency class D
according to regulation (EU) No 2019/2015

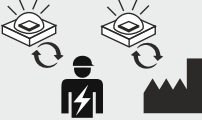

Die Lichtquelle dieser Leuchte darf nur vom Hersteller oder einem
von ihm beauftragten Servicetechniker oder einer vergleichbar
qualifizierten Person ersetzt werden. DIN EN 60598-1 / IEC 60598-1

The light source contained in this luminaire shall only be
replaced by the manufacturer or his service agent or a similar
qualified person. DIN EN 60598-1 / IEC 60598-1

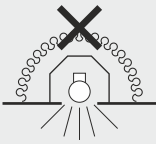

Nicht zur Abdeckung mit Wärmedämm-Material geeignete Leuchten!

Not to be covered with thermal insulation material!



CCT [K] 4000

 [mA]	Φ [lm]	P [W]
300	1700	11,0
350	1950	13,0
400	2200	15,0
450	2450	17,0
500	2700	19,0
550	2950	21,0
600	3200	22,0
650	3400	24,0
700	3600	26,0
750	3990	28,0
800	4100	30,0
850	4300	31,0
900	4500	33,0
950	4750	35,0
1000	5000	37,0
1050	5150	39,0

CCT [K] 3000

 [mA]	Φ [lm]	P [W]
300	1650	11,0
350	1870	13,0
400	2100	15,0
450	2340	17,0
500	2550	19,0
550	2800	21,0
600	3000	22,0
650	3250	24,0
700	3450	26,0
750	3700	28,0
800	3900	30,0
850	4100	31,0
900	4330	33,0
950	4500	35,0
1000	4700	37,0
1050	4950	39,0

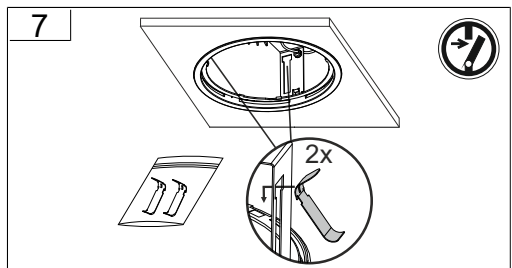
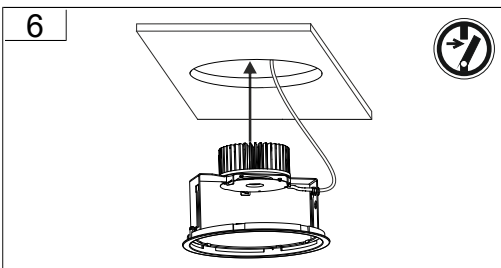
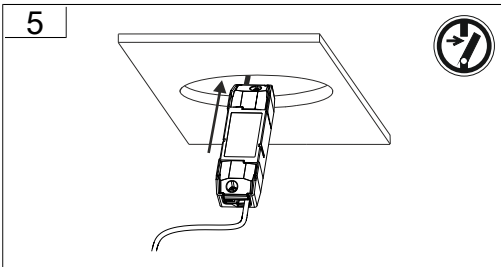
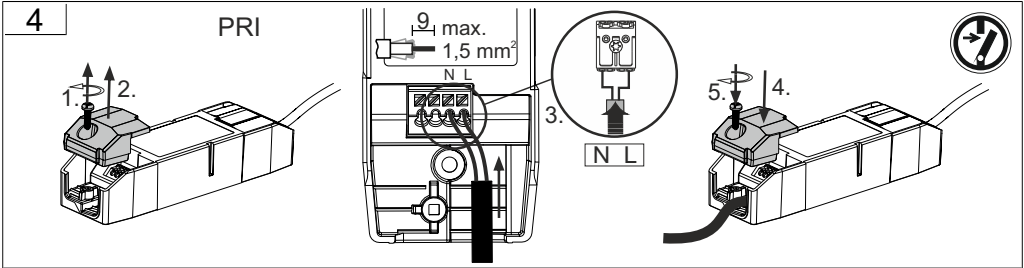
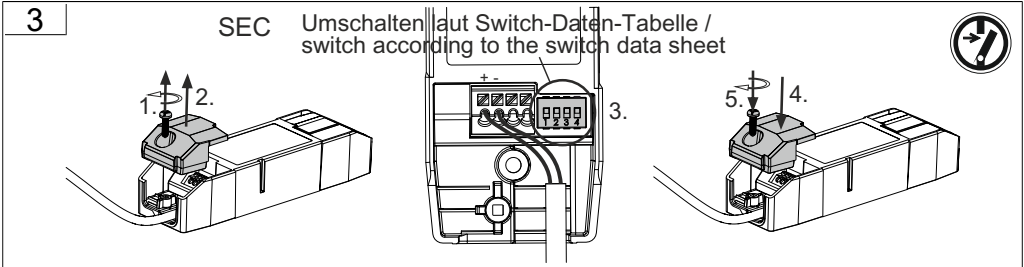
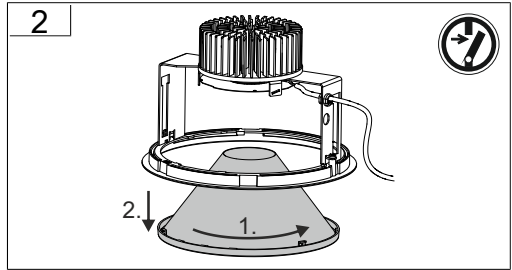
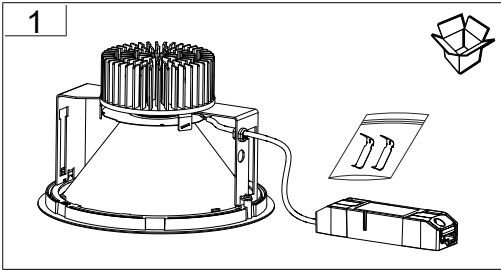



8

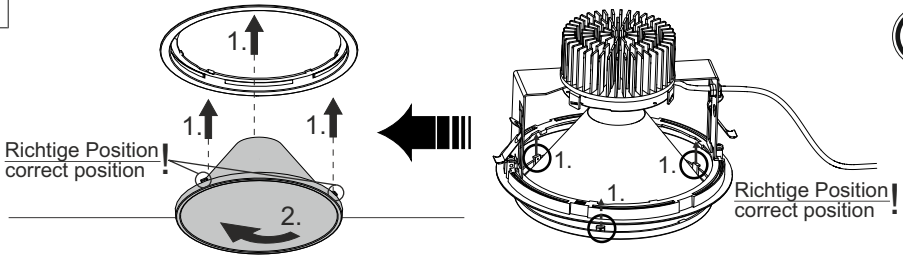

9

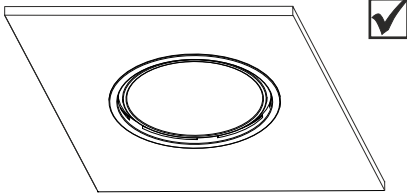

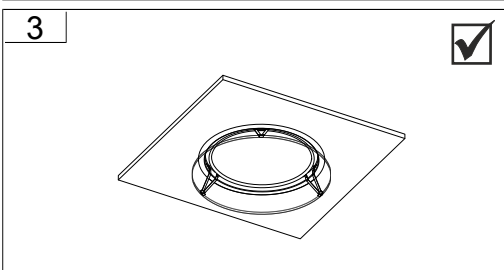
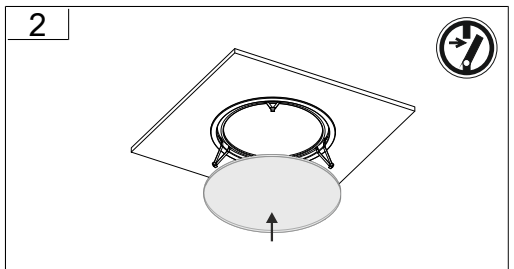
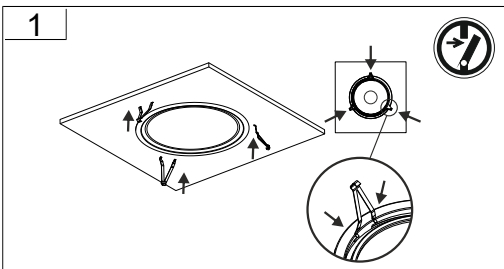
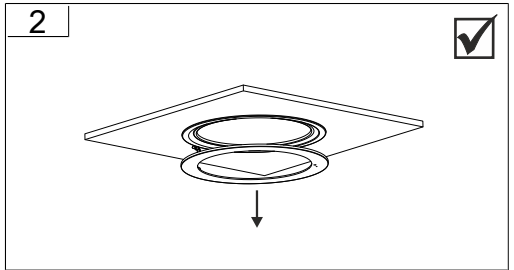
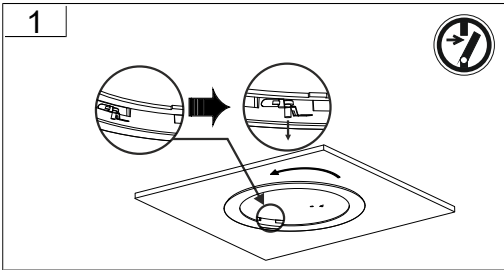
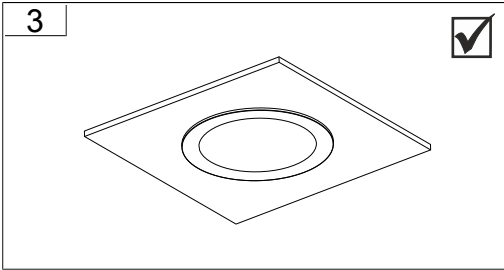
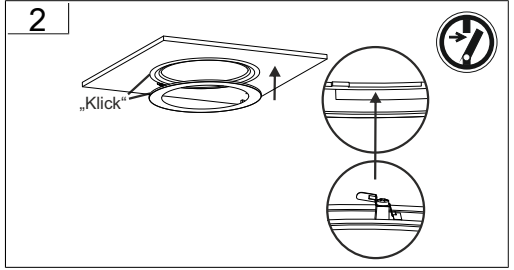
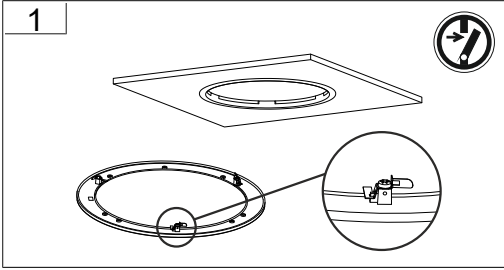

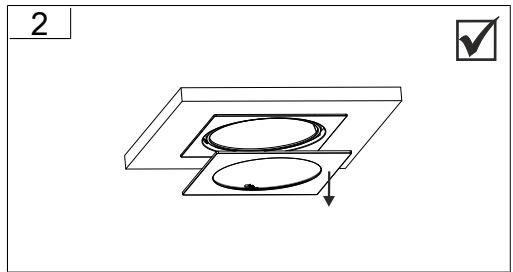
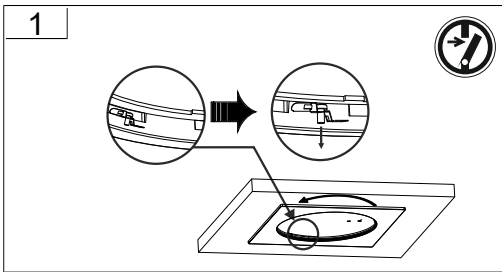
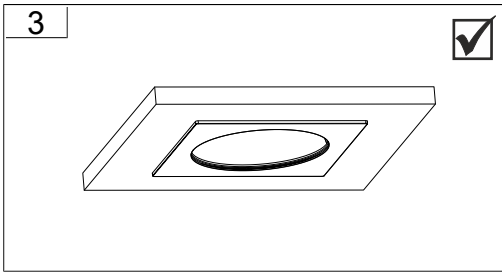
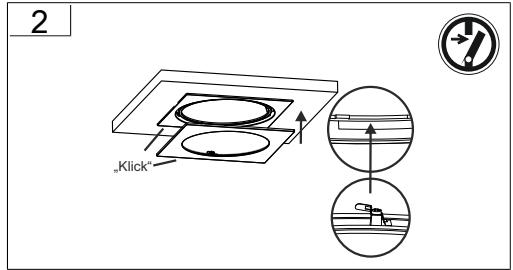
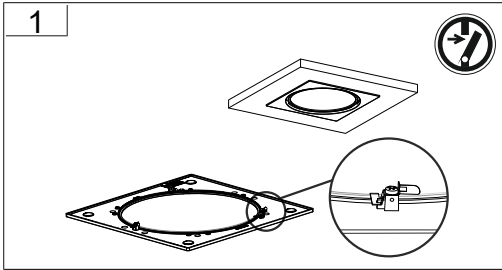

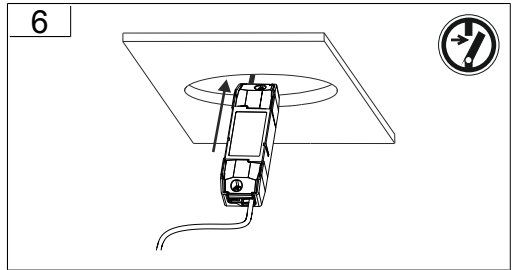
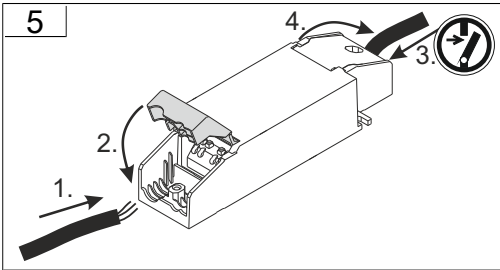
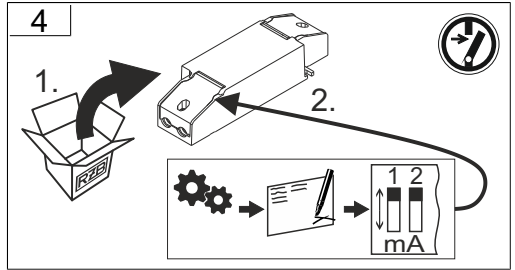
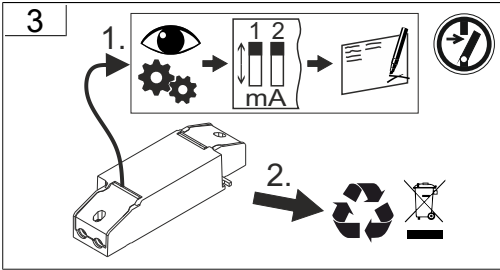
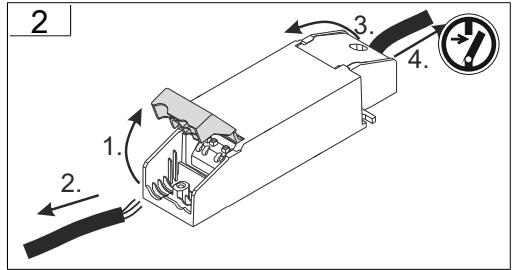
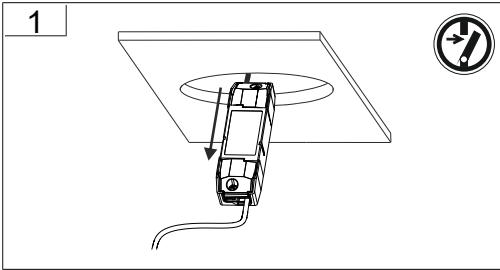

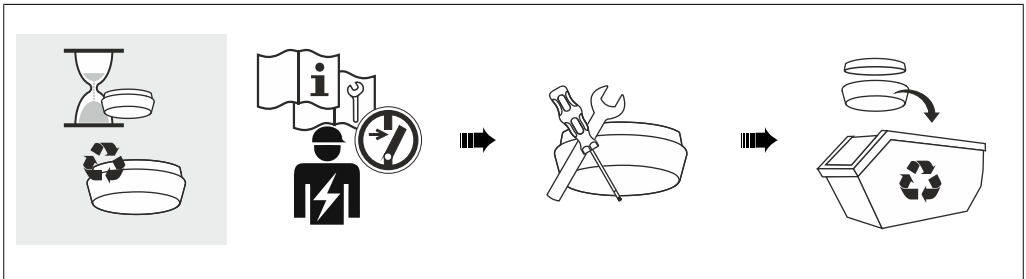
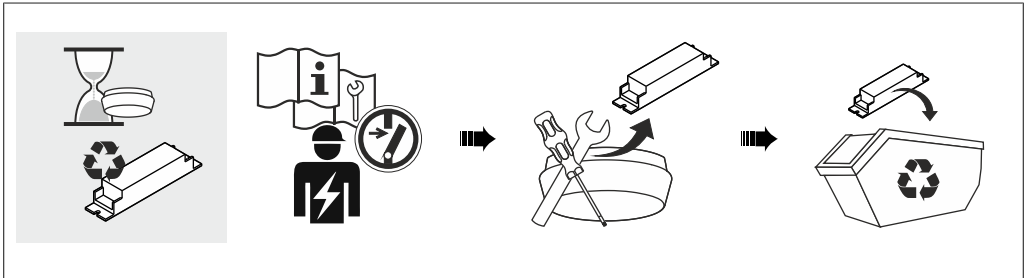
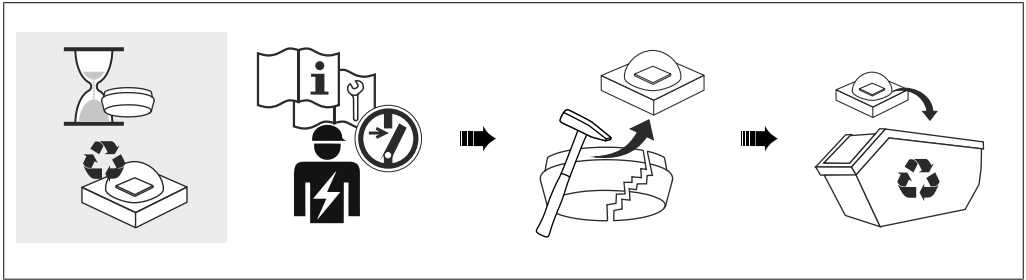



Ausschnitt / cutout

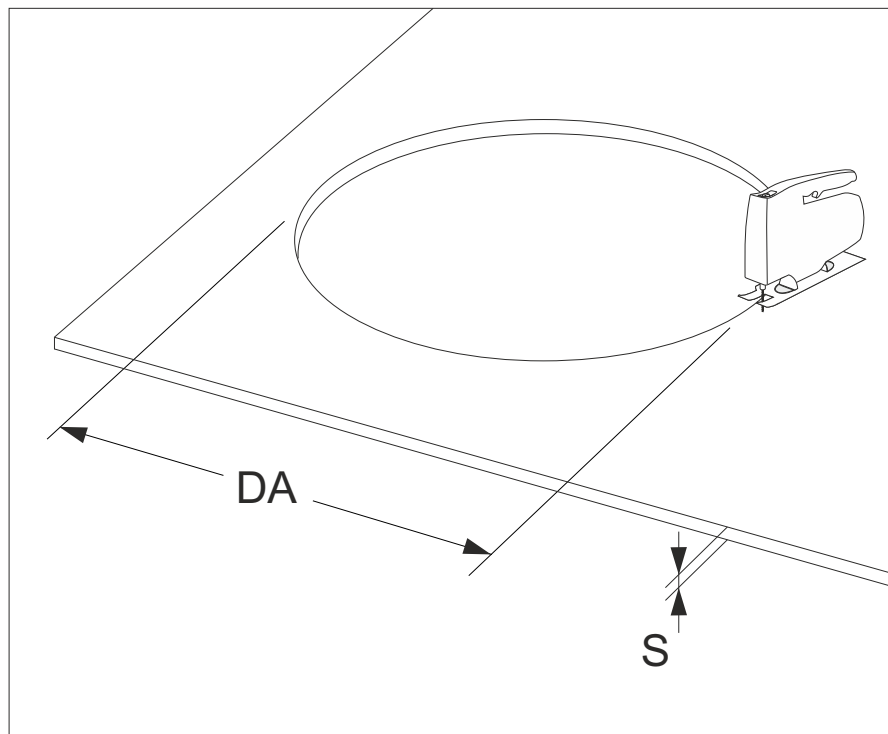

RZB - Rudolf Zimmermann, Bamberg GmbH

🏠 Rheinstraße 16, 96052 Bamberg

☎ 0951/7909-0

📄 0951/7909-198

🌐 info@rzb-leuchten.de