

# INSTRUCTION

LINEDO  
951200.002.476.000



≈ 220 - 240 V 0/50/60 Hz IP 20



 5 x 2,5 mm<sup>2</sup>

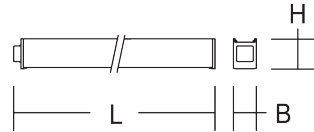

L 1164, B 58, H 76



2,72 kg

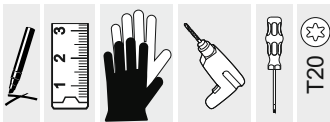



### Allgemeine Sicherheitshinweise

- Der elektrische Anschluss muss ordnungsgemäß nach geltenden Normen und den nationalen sowie internationalen Sicherheits- und Unfallverhütungsvorschriften erfolgen.
- Beschädigte Leuchten dürfen nicht betrieben werden.
- Keine Haftung für Schäden durch unsachgemäßen Einsatz.
- Bei Instandsetzung nur Originalteile verwenden.
- Tragfähigkeit der Decke und Befestigungselemente sicherstellen.

### Betrieb der Leuchte

- Die unzulässigen Umgebungstemperaturen reduzieren die Lebensdauer der Leuchte, im Extremfall droht der Frühausfall.
- Zur Vermeidung von EMV-Problemen die Durchgangsverdrahtung nicht entlang der Leuchtenverdrahtung führen.
- Steuereingänge von dimmbaren Leuchten mit handelsüblichen für Netzspannung geeigneten Leitungen anschließen

### Manipulationen unserer Produkte sind unzulässig

Veränderung, Umarbeitung, Umkennzeichnung von Produkten sowie deren Verpackung sind unzulässig und verletzen u.a. unsere eingetragenen Warenzeichenrechte. Solche Modifikationen können technische Eigenschaften unserer Produkte negativ beeinflussen, diese zerstören und möglicherweise Folgeschäden an anderen Objekten verursachen. Für durch derartige Modifikationen verursachte Schäden kann der Hersteller in keinem Fall verantwortlich gemacht werden.



### General Safety Information

- Electric connection must be appropriate according to all applicable standards and other national and international safety and accident prevention regulations.
- Damaged luminaires must not be operated.
- No liability is accepted for damages resulting from improper use.
- Use genuine parts only for repair.
- Ensure stability of the ceiling and fastening elements.

### Operation of the luminaire

- Exceeding the permissible ambient temperature will reduce the luminaire's lifecycle, resulting in premature failure in extreme cases.
- Avoid ESD problems by not routing feed-through wiring directly along the wiring of the luminaire.
- Connect control inputs of dimmable luminaires with standard cables suitable for power supply voltage.

### Manipulation of our products is not permitted

Modifications, reworking, re-labelling of products as well as their package is not permitted and infringes, amongst others, our registered trademark rights. Such modifications may affect technical properties of our products, damage them and possibly cause consequential damage to other objects. The manufacturer shall not be responsible under any circumstances for damage caused by such modifications.



DIN EN IEC 61340-5-1

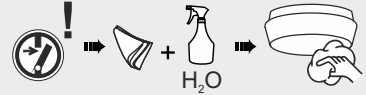

Bei Fragen zu unseren Symbolen, besuchen Sie folgende Webseite:

If you have any questions about our signs, visit the following website:

[www.rzb.de/fileadmin/assets/downloads/PDF/RZB\\_Symbolklaerung.pdf](http://www.rzb.de/fileadmin/assets/downloads/PDF/RZB_Symbolklaerung.pdf)



Stecker / Plug	Pendelmontage / Pendant mounting	Einspeisung Mitte / Feed in the middle
Buchse / Socket	Deckenmontage / Ceiling mounting	Einspeisung Mitte / Feed in the middle
Pendelmontage / Pendant mounting	Einspeisung Anfang von oben / Feed beginning from above	Deckenmontage / Ceiling mounting
Deckenmontage / Ceiling mounting	Einspeisung Anfang von oben / Feed beginning from above	Einspeisung Anfang seitlich / Feed beginning from the side
Verdrahtung anpassen / Adapt wiring	Pendelmontage / Pendant mounting	L-Verbinder / L-Connector
Werkseinstellungen / Factory setting	Deckenmontage / Ceiling mounting	L-Verbinder / L-Connector
	Pendelmontage / Pendant mounting	X,T-Verbinder / X,T-Connector
	Deckenmontage / Ceiling mounting	X,T-Verbinder / X,T-Connector

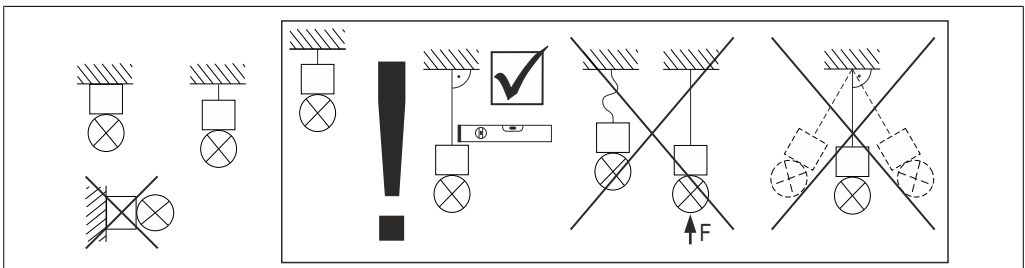



1



2

L1  
L2  
L3  
N

  
L1, L2, L3 ≤ 16 A





 ≤ 9 kg

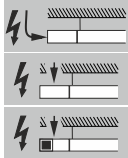
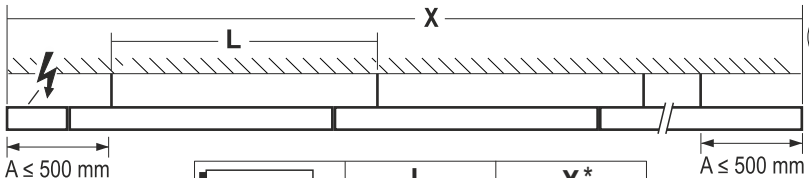

3a





 1x  
≤ 12 kg

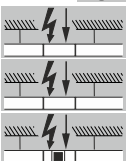
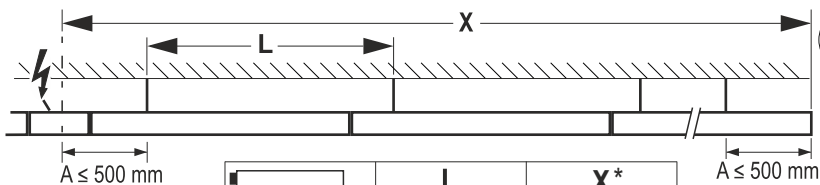

	L	X*
	≤ 4500 mm	≤ 60000 mm
	≤ 2270 mm	≤ 50000 mm

\* R<sub>PE</sub> < 0,5 Ω  
EN 60598

3b



 1x  
≤ 12 kg

	L	X*
	≤ 4500 mm	≤ 60000 mm
	≤ 2270 mm	≤ 50000 mm

\* R<sub>PE</sub> < 0,5 Ω  
EN 60598

3c

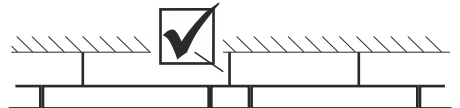
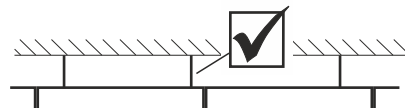
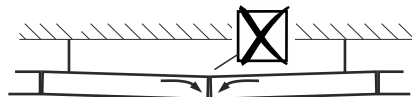
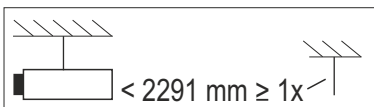



**3d**

	L	X*
4547 mm	≤ 2200 mm	≤ 60000 mm
2291 mm	≤ 1100 mm	≤ 50000 mm

\*  $R_{PE} < 0,5 \Omega$   
EN 60598

500 mm  
200 mm  
 $A \leq 500$  mm

!  $\downarrow 1x$   
 $\leq 12$  kg

**3e**

	L	X*
4547 mm	≤ 2200 mm	≤ 60000 mm
2291 mm	≤ 1100 mm	≤ 50000 mm

\*  $R_{PE} < 0,5 \Omega$   
EN 60598

210 mm  
500 mm  
 $A \leq 500$  mm

!  $\downarrow 1x$   
 $\leq 7$  kg

2x

**3f**

	L	X*
4547 mm	≤ 2200 mm	≤ 60000 mm
2291 mm	≤ 1100 mm	≤ 50000 mm

\*  $R_{PE} < 0,5 \Omega$   
EN 60598

500 mm  
125 mm  
 $A \leq 500$  mm

!  $\downarrow 1x$   
 $\leq 7$  kg

**3g**

$< 2291$  mm  $\geq 1x$

$< 2291$  mm  $< 1x$

**4a**

4547 mm	$\geq 2x$
2291 mm	$\geq 2x$
$< 2291$ mm	$\geq 1x$

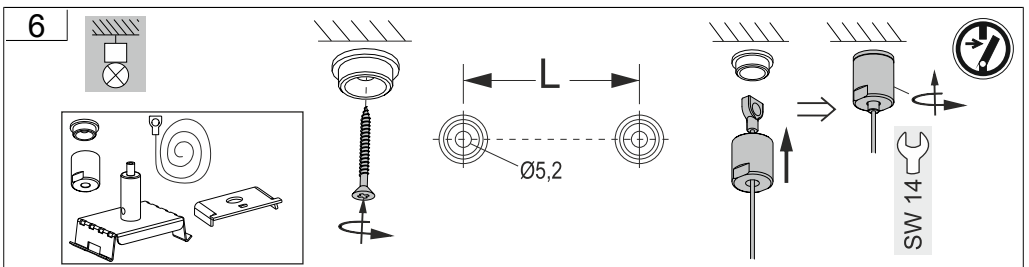
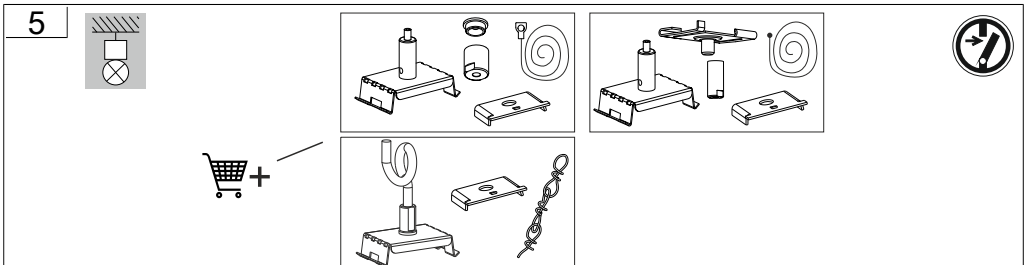
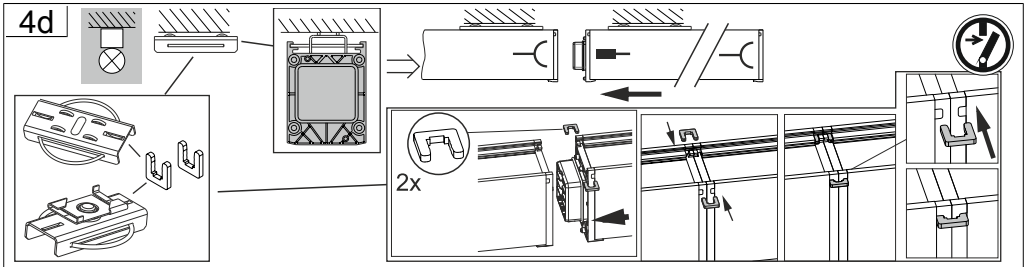
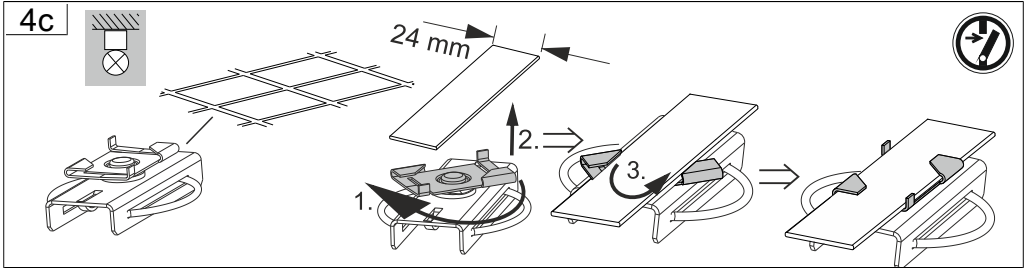
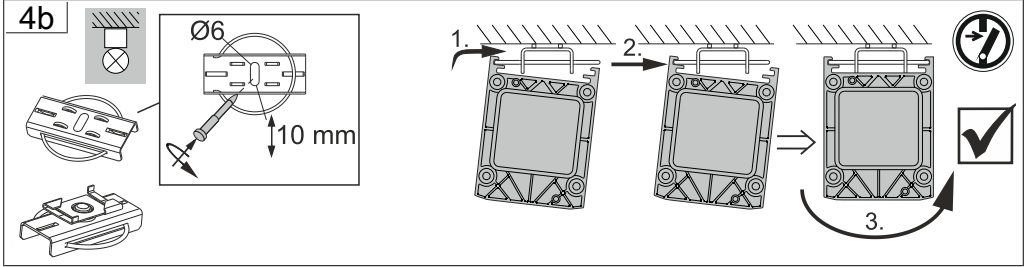

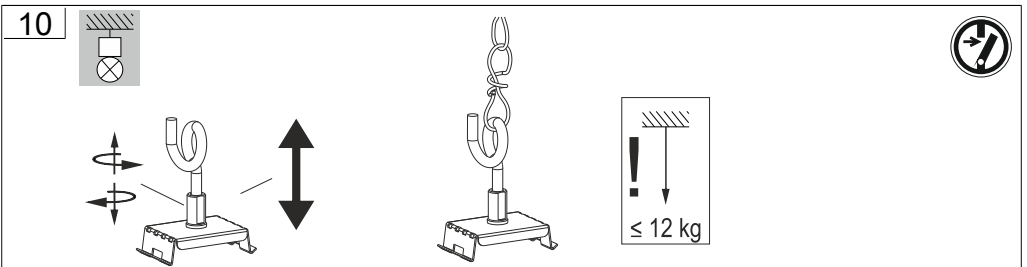
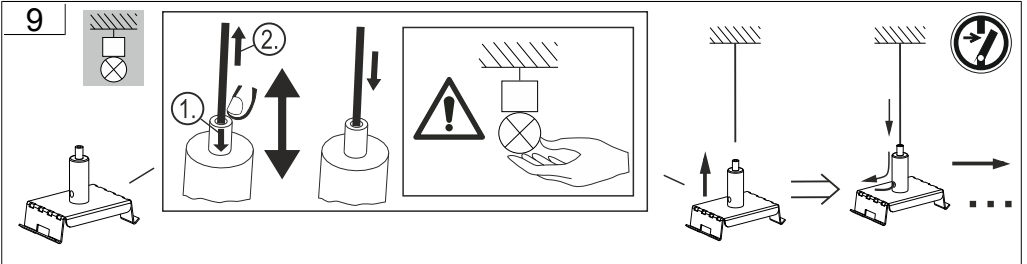
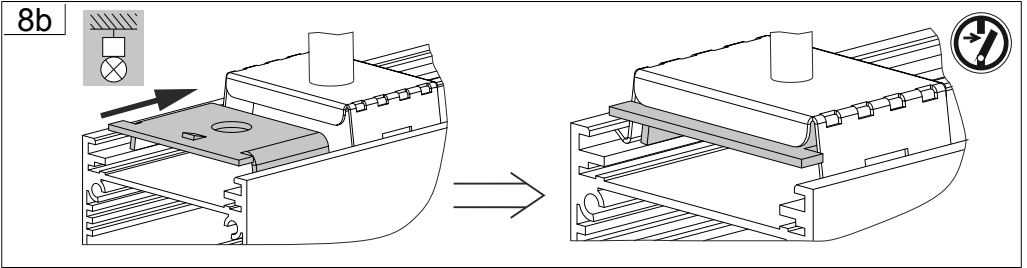
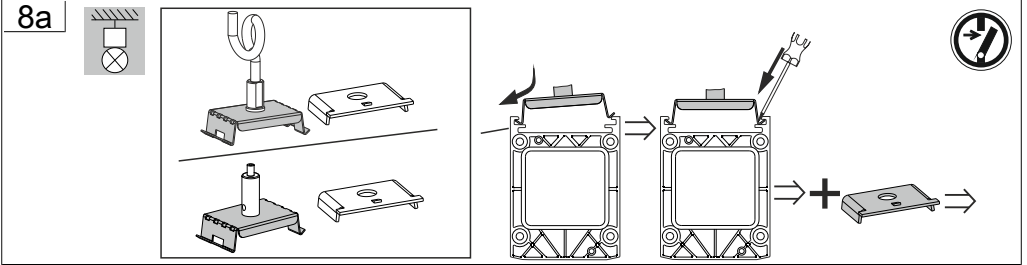
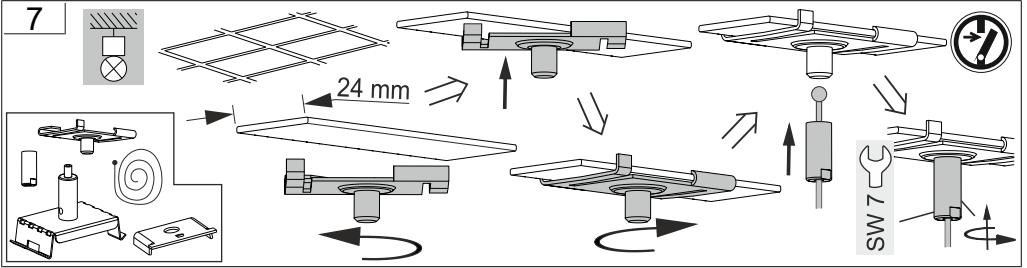



11

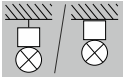

Werkseinstellung L1 /  
Factory setting L1

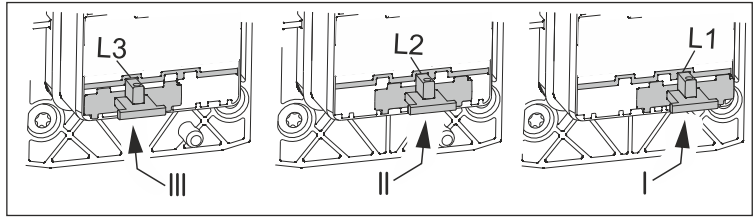
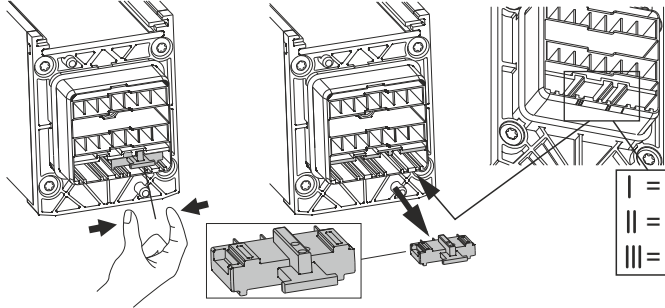
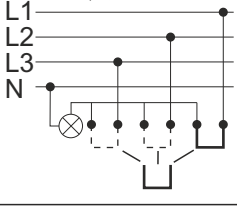

12a

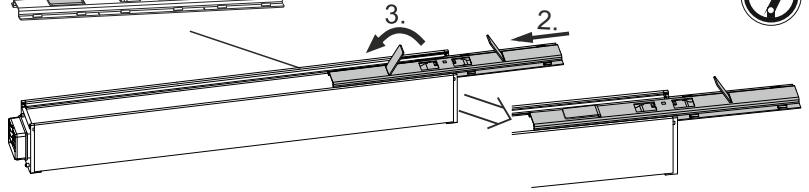
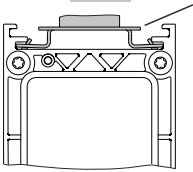

12b

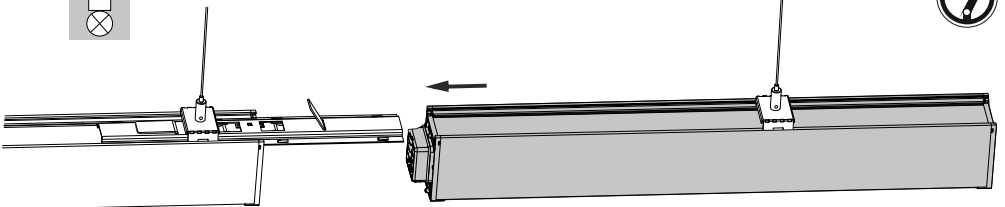

12c

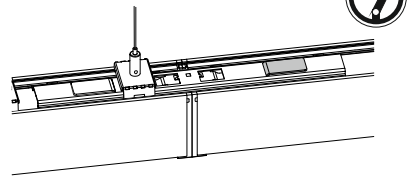
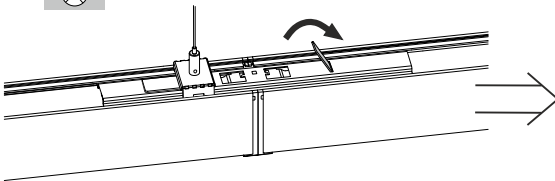





13

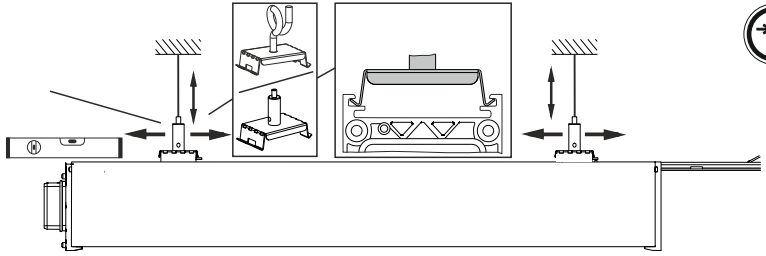

14a

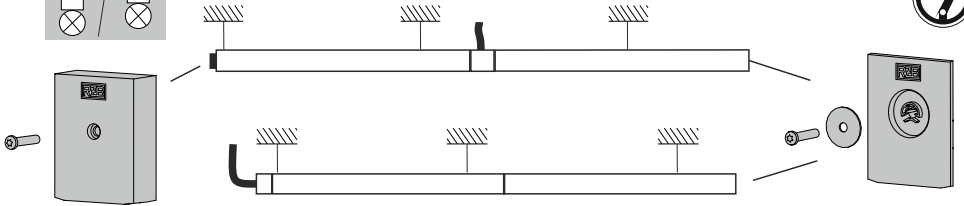
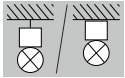

14b

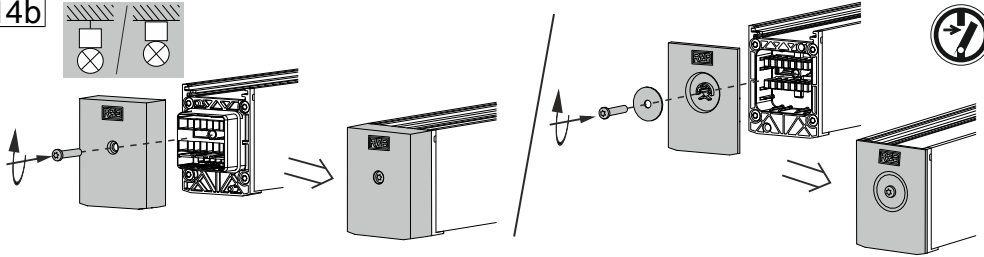
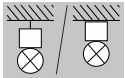

15

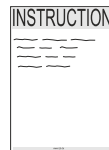
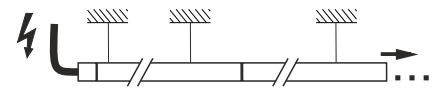
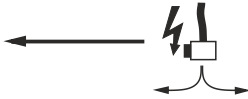
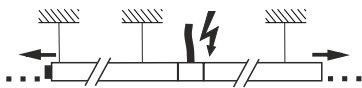







RZB - Rudolf Zimmermann, Bamberg GmbH

 Rheinstraße 16, 96052 Bamberg

 0951/7909-0

 0951/7909-198

 [info@rzb-leuchten.de](mailto:info@rzb-leuchten.de)